

Town of Chester
203 Middlesex Avenue
Chester Connecticut 06412



telephone: 860-526-0013
facsimile: 860-526-0004
web page: chesterct.org

NOTICE OF APPLICATION

Date: April 3, 2020

To: Abutting Property Owners
Owners Across Street or Rights of Way

From: Applicant
John R. Schroeder, AIA LLC
69-2 Main Street
Chester, CT 06412

Subject: Application to Conduct a Regulated Activity within an Inland Wetland
or Watercourse in Chester, Connecticut.

An application is being made to the Chester Inland Wetlands & Watercourses Agency. Regulations provide that all adjacent property owners must be given notice of all applications. Should you have any questions or comments in writing or in person, they may be directed to the Inland Wetlands & Watercourses Agency, Town Hall, 203 Middlesex Avenue, Chester, CT 06412.

Applicant Name: John R. Schroeder, AIA LLC

Property Owner: Tyler and Bria Gilbert

Location of Property: 43-47 Main Street Chester, CT Map 14 Lot 544

Description of Proposed Activity:

Three existing decks and stairs (in very poor condition) to be removed along with associated pier foundations. New decks and pier foundations to be installed in their place. All new pier foundations to be installed using a combination of hand digging and small portable equipment.

http://www.mainstreetmaps.com/ct/chester/public.asp

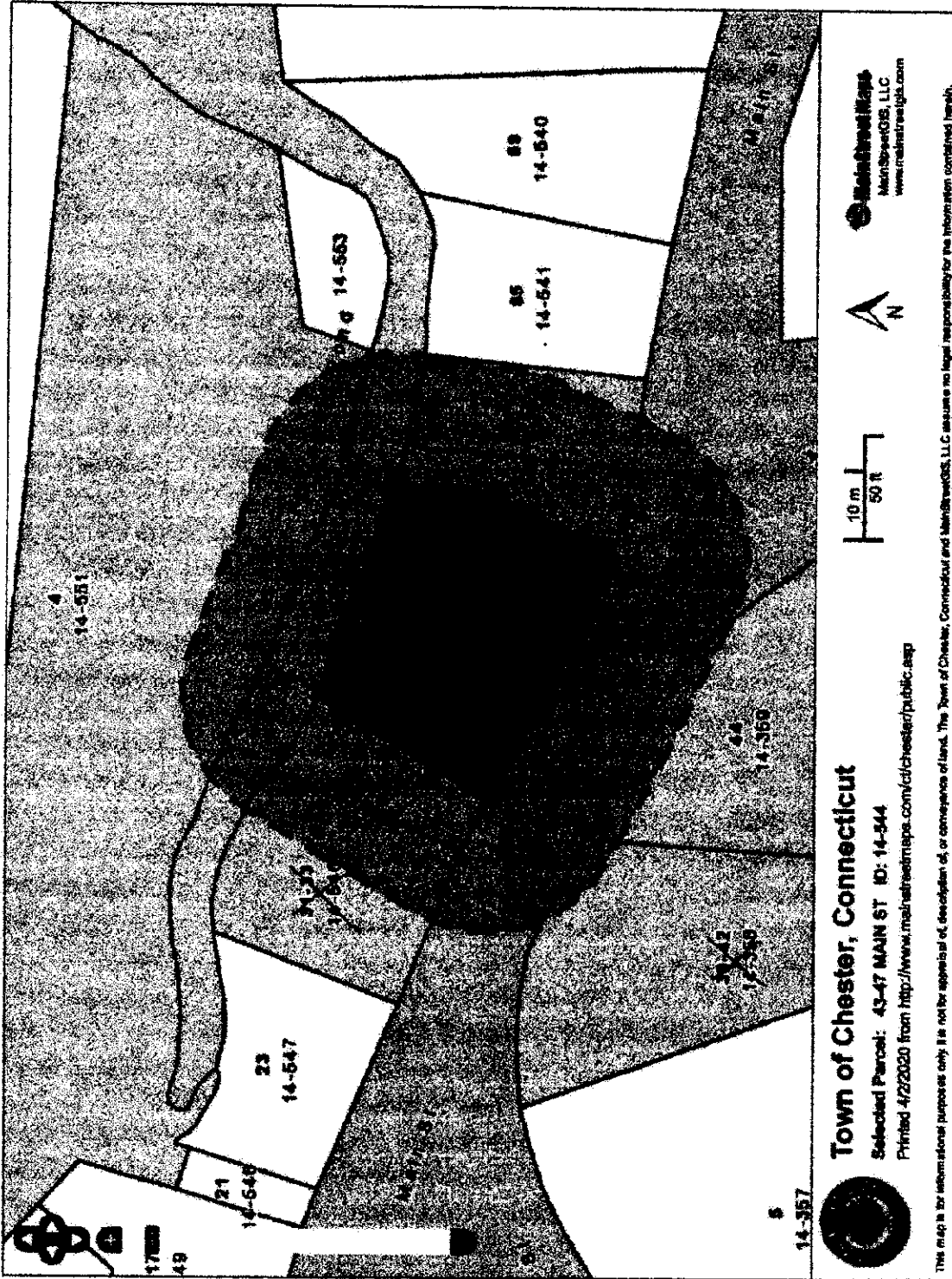

4/2/2020, 1:47 PM

http://www.mainstreetmaps.com/MASTERIII/query/labels_5160.asp?b=CT/Chester/

~~Parcel ID: 14-558
CHESTER COVE LLC
PO BOX 340
CHESTER CT 06412~~

Parcel ID: 14-359
ROBINSON PRISCILLA M
PO BOX 326
CHESTER CT 06412

~~Parcel ID: 14-542
L & E REAL ESTATE LLC
59-61 MAIN ST
CHESTER CT 06412~~

Parcel ID: 14-543
GRIMMER LAURA
51 MAIN ST
CHESTER CT 06412

~~Parcel ID: 14-544
CORMIER RYAN E & CORMIER DEVON
C
36 CEDARWOOD LANE
OLD SAYBROOK CT 06475~~

Parcel ID: 14-545
AMERICAN LIGHT LLC
C/O WILLIAM L. SCHAEFFER
PO BOX 396
CHESTER CT 06412

~~Parcel ID: 14-546
33 MAIN ST-CHESTER LLC
4 OLD DEPOT RD
CHESTER CT 06412~~

Parcel ID: 14-551
CHESTER CENTER LLC
PO BOX 450
CHESTER CT 064120450